

# CITYWIDE BIKE LANES PAVEMENT MARKING REFURBISHMENT

## SURTAX-FUNDED MUNICIPAL TRANSPORTATION PROJECT NO. BC-WESTON-FY2020-00002



**MAP Broward**  
 Mobility Advancement Program  
 Brought to you by the  
 Penny For Transportation

### SHEET LIST TABLE

SHEET NO.	SHEET TITLE
1	COVER PAGE
2	SITE PLAN
3	BCTED TRAFFIC PAVEMENT MARKINGS & SIGNS DETAIL
4	BCTED BICYCLE PAVEMENT MARKINGS AND SIGNS DETAILS SHEET 1 OF 2
5	BCTED BICYCLE PAVEMENT MARKINGS AND SIGNS DETAILS SHEET 2 OF 2

**NOTES:**

- RESPONSIBILITY FOR THE USE OF THESE PLANS FOR ANY PURPOSE PRIOR TO SECURING PERMITS FROM ALL AGENCIES HAVING JURISDICTION OVER THIS PROJECT WILL FALL SOLELY UPON THE USER.
- AN ELECTRONIC CAD FILE WILL BE PROVIDED FOR SURVEY LAYOUT.

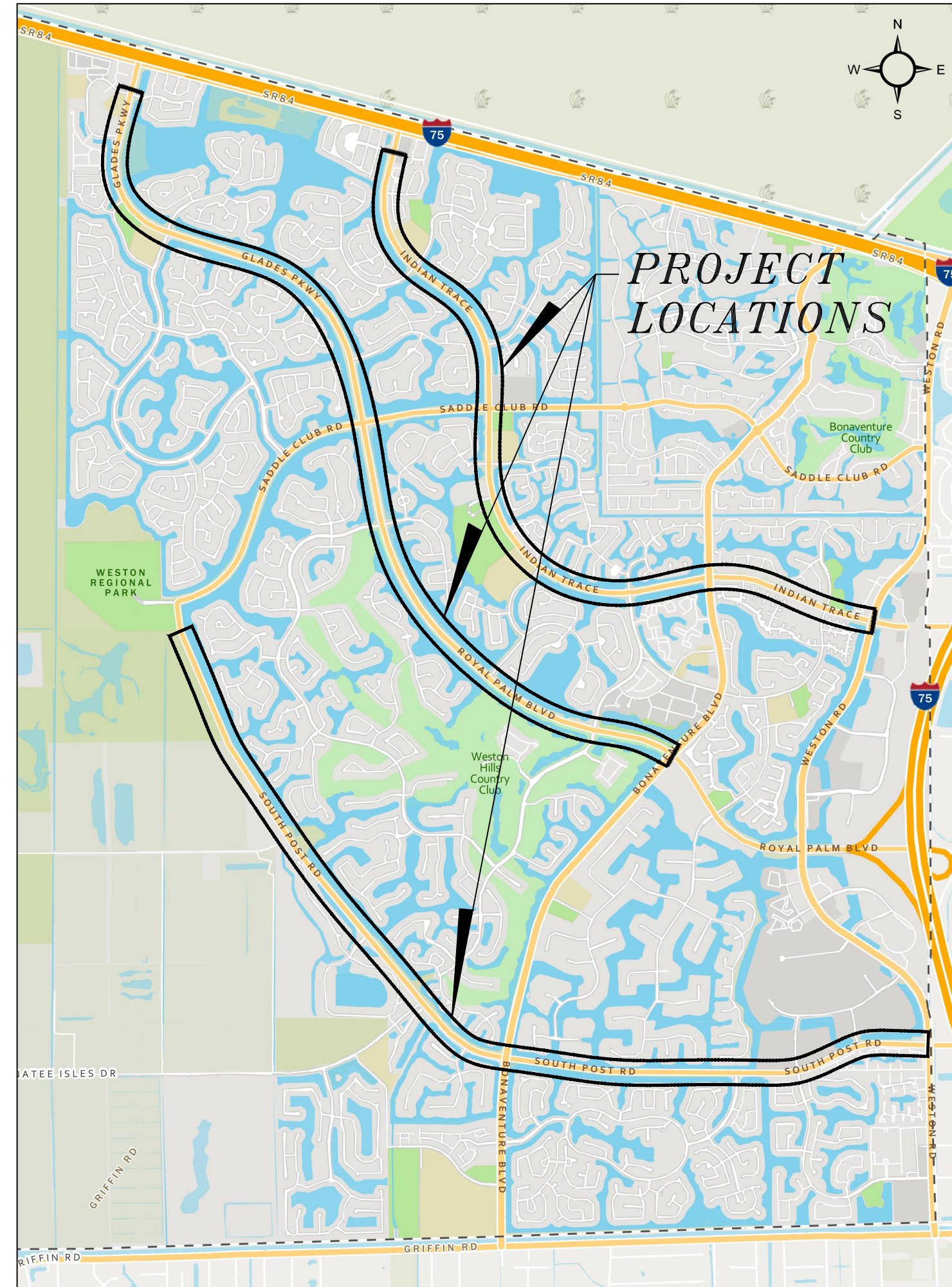

**PROJECT KEY MAP**

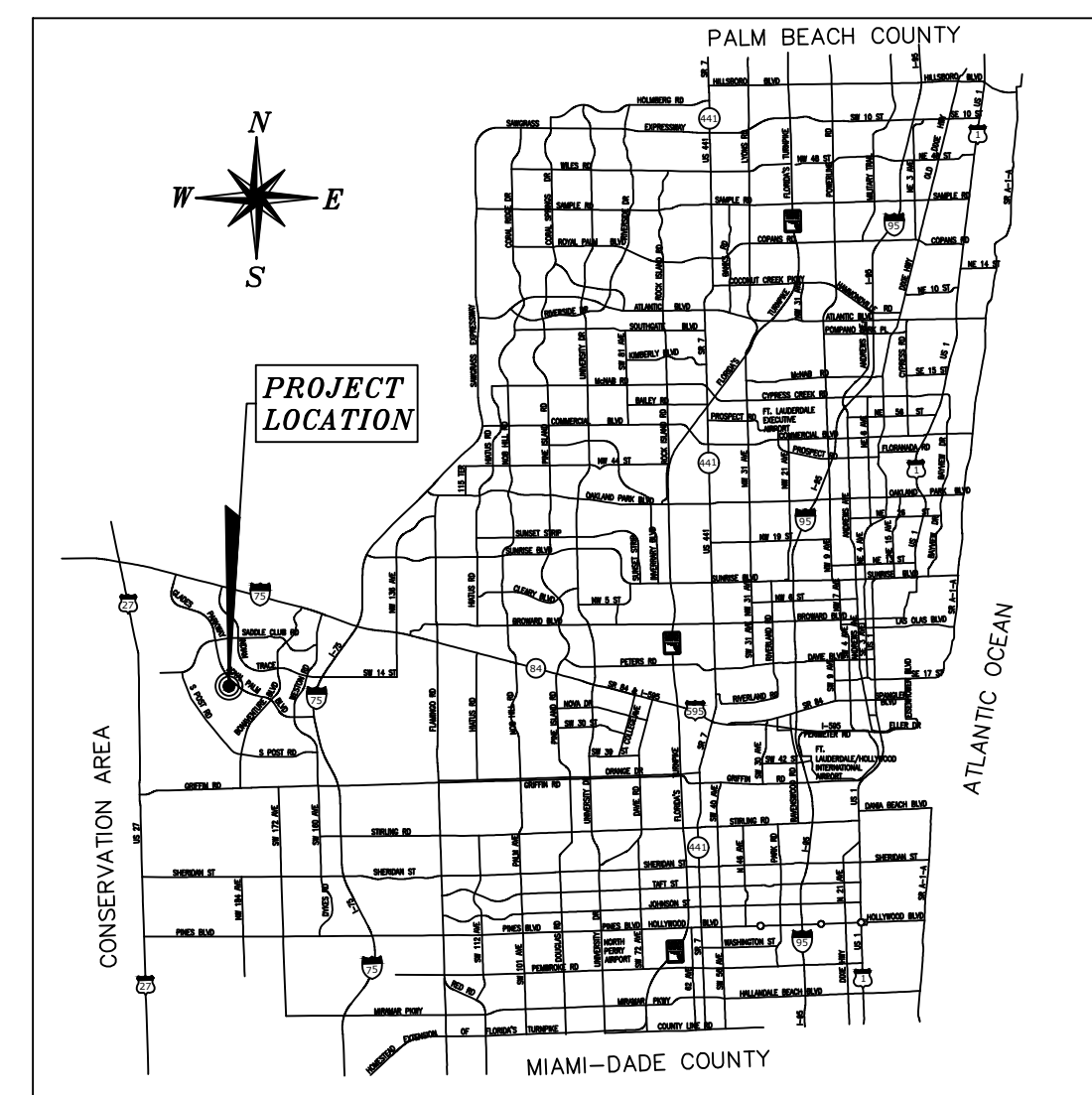

**LOCATION PLAN**



### CITY OFFICIALS

MAYOR: MARGARET BROWN  
 COMMISSIONERS: BYRON L. JAFFE  
 MARY MOLINA-MACFIE  
 CHRIS EDDY  
 HENRY MEAD  
 CITY MANAGER/CEO: DONALD P. DECKER

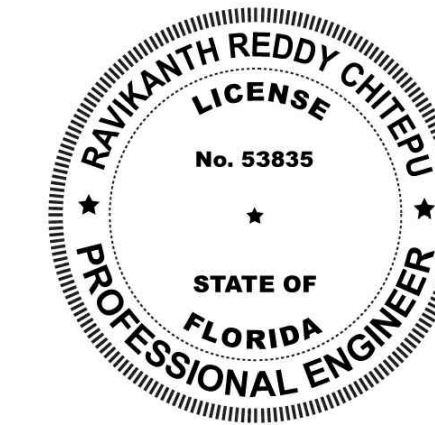

THIS ITEM HAS BEEN DIGITALLY SIGNED AND SEALED BY

ON THE DATE ADJACENT TO THE SEAL

PRINTED COPIES OF THIS DOCUMENT ARE NOT CONSIDERED SIGNED AND SEALED AND THE SIGNATURE MUST BE VERIFIED ON ANY ELECTRONIC COPIES

CITY OF WESTON PUBLIC WORKS  
 2599 SOUTH POST ROAD  
 WESTON FL 33327  
 954-385-2600

REDDY CHITEPU, P.E. 53835

THE ABOVE NAMED PROFESSIONAL ENGINEER SHALL BE RESPONSIBLE FOR THE FOLLOWING SHEETS IN ACCORDANCE WITH THE RULE 61G15-23.004, F.A.C.

SHEET No.	SHEET DESCRIPTION
1	COVER PAGE
2	SITE PLAN

PERMITTING AGENCIES	DATE SUBMITTED	CG/ACOW INITIALS	DATE APPROVED	PERMIT NUMBER
CITY OF WESTON - BUILDING DEPARTMENT APPROVAL				
CITY OF WESTON - UTILITY ENGINEERING APPROVAL				
CITY OF WESTON - LANDSCAPING APPROVAL				
CITY OF WESTON - ZONING APPROVAL				

NO.	DATE	REVISION	BY

Engineering Division  
 Drawn by: A. Abdou / J. Casio Date: 07-12-22  
 Checked by: RC Date: 07-12-22  
 As-built drawn by: Date:  
 Field Inspector: Date:  
 Field Book No.:

**COVER PAGE**  
**CITYWIDE BIKE LANES PAVEMENT MARKING REFURBISHMENT**  
 Weston, Florida

**CITY OF WESTON**  
**DEPARTMENT OF PUBLIC WORKS**  
 2599 South Post Road, Weston, Florida 33327

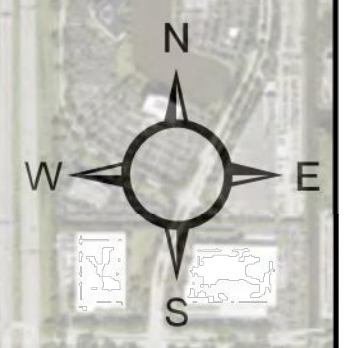

# Citywide Bike Lanes Pavement Marking Refurbishment

Length (lf.)	
Glades Pkwy. WB:	10,981
Glades Pkwy. EB:	11,011
Royal Palm Blvd. WB:	15,755
Indian Trace WB:	19,346
Indian Trace EB:	19,441
South Post Rd. WB:	23,271

Map #: PW 20-24  
Date: 5/13/2020

Disclaimer:  
The City of Weston has made every effort to accurately verify the information contained as part of this product. However, some of the data provided is based on information obtained from other agencies and based on educated assumptions and estimates. As a result, we encourage you to independently verify all the information contained herein since the City nor any of its service providers can be held responsible for any damages due to errors or omissions of this product. Depiction of boundaries is not authoritative and should not be used for engineering purposes.

Engineering Division	
Drawn by: I. Casio	Date: 07-12-22
Checked by: RC	Date: 07-12-22
As-built drawn by:	Date:
Field Inspector:	
Field Book No.:	

**SITE PLAN**  
CITYWIDE BIKE LANES PAVEMENT MARKING REFURBISHMENT  
Weston, Florida

**CITY OF WESTON**  
DEPARTMENT OF PUBLIC WORKS  
2599 South Post Road, Weston, Florida 33327

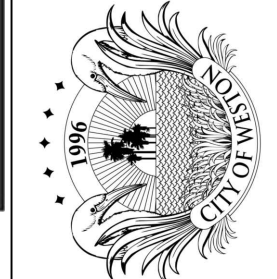

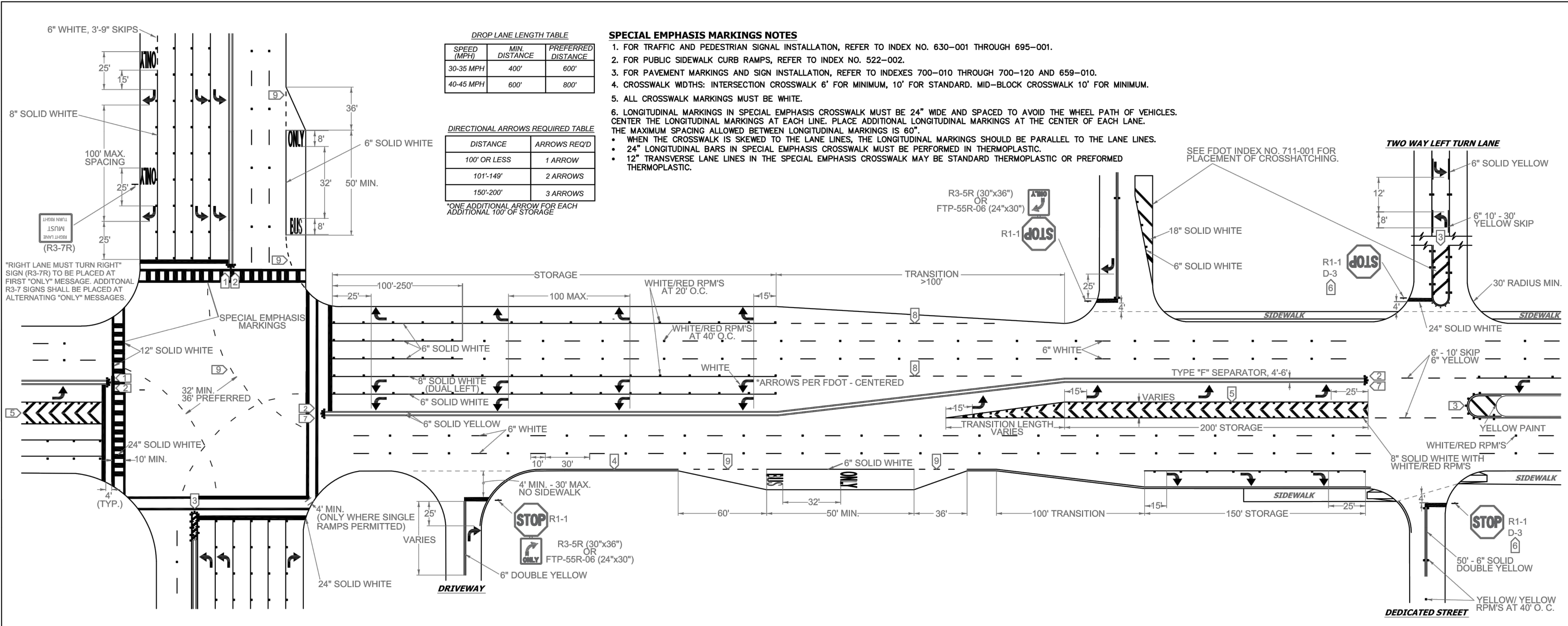

- NOTES**
- ALL PAVEMENT MARKINGS SHALL BE ALKYD BASED THERMOPLASTIC AND FULLY RETROREFLECTORIZED.
  - ALL PAVEMENT MARKINGS ON PAVEMENT SYSTEMS SHALL BE 3M 380/381 SERIES TAPE OR EQUIVALENT AND APPLIED WITH P60 ADHESIVE AS PER MANUFACTURER'S SPECIFICATIONS.
  - ALL PAVEMENT MARKINGS AND SIGNING SHALL BE IN ACCORDANCE WITH THE "MANUAL ON UNIFORM TRAFFIC CONTROL DEVICES", BCTD STANDARDS, AND FDOT DESIGN STANDARDS.
  - SEE FDOT INDEX NO 706-001 FOR PLACEMENT OF RPM'S (FOR BULLNOSE RPM TREATMENT, SEE LEGEND NO. 1)
  - RPM'S SHALL BE CLASS "B" OR EQUIVALENT, APPLIED WITH EPOXY OR BITUMINOUS ADHESIVE.
  - FDOT APPROVED SEALER SHALL BE USED WHEN APPLYING MARKINGS ON CONCRETE.
  - FOR BIKE LANE DETAILS SEE FDOT INDEX NO. 711-002.
  - MARKINGS IN AND ADJACENT TO BIKE LANES SHALL BE THERMOPLASTIC WITH A MIXTURE OF 50% GLASS SPHERES AND 50% SHARP SILICA SAND APPLIED AT A RATE DETERMINED BY THE MANUFACTURER'S SPECIFICATIONS.
  - EXISTING MARKINGS SHALL BE REMOVED BY WATER BLASTING OR SAND BLASTING.
  - ALL STOP LINES TO BE 4' BEHIND CROSSWALK OR SIDEWALK.
  - PAVEMENT MARKING REFLECTIVITY SHALL BE UNIFORM ACROSS THE ENTIRE STRIPE AND SHALL HAVE A MINIMUM REFLECTIVITY READING OF 250 MILLICANDELAS FOR WHITE AND 175 MILLICANDELAS FOR YELLOW.
  - ALL PRODUCTS MUST BE ON FDOT'S APPROVED PRODUCTS LIST (APL).
  - RPMS SHALL NOT BE INSTALLED ADJACENT TO BIKE LANES.

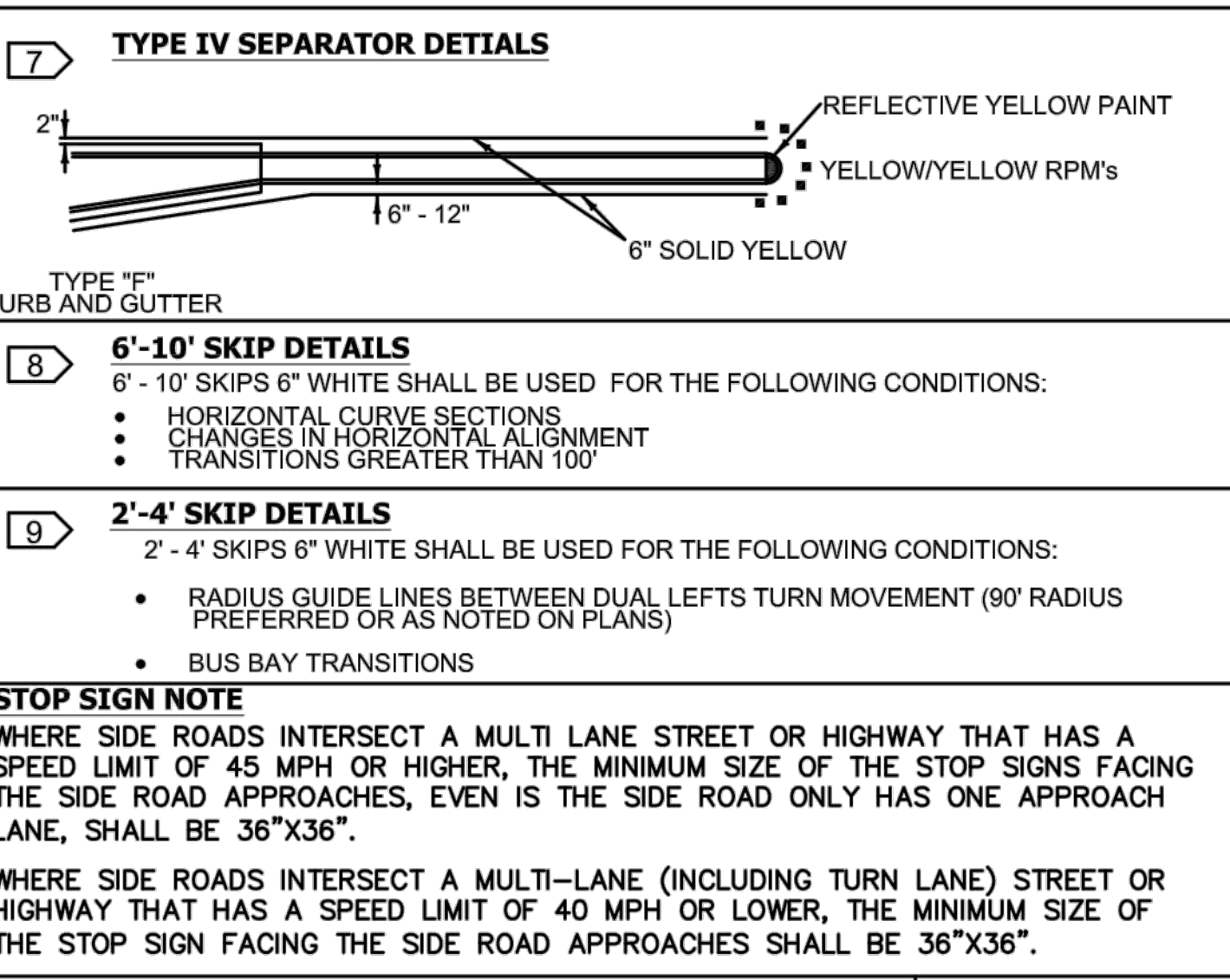
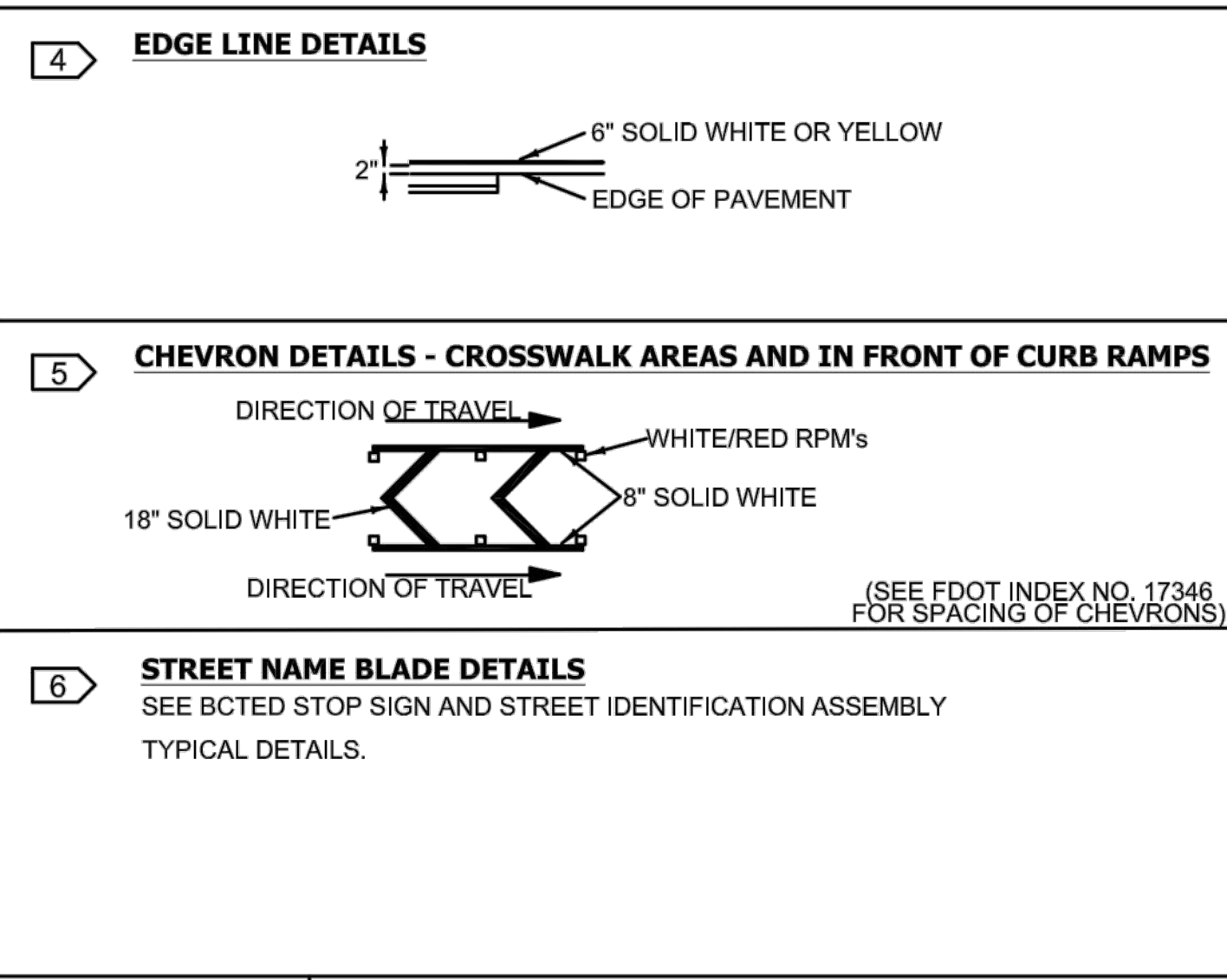
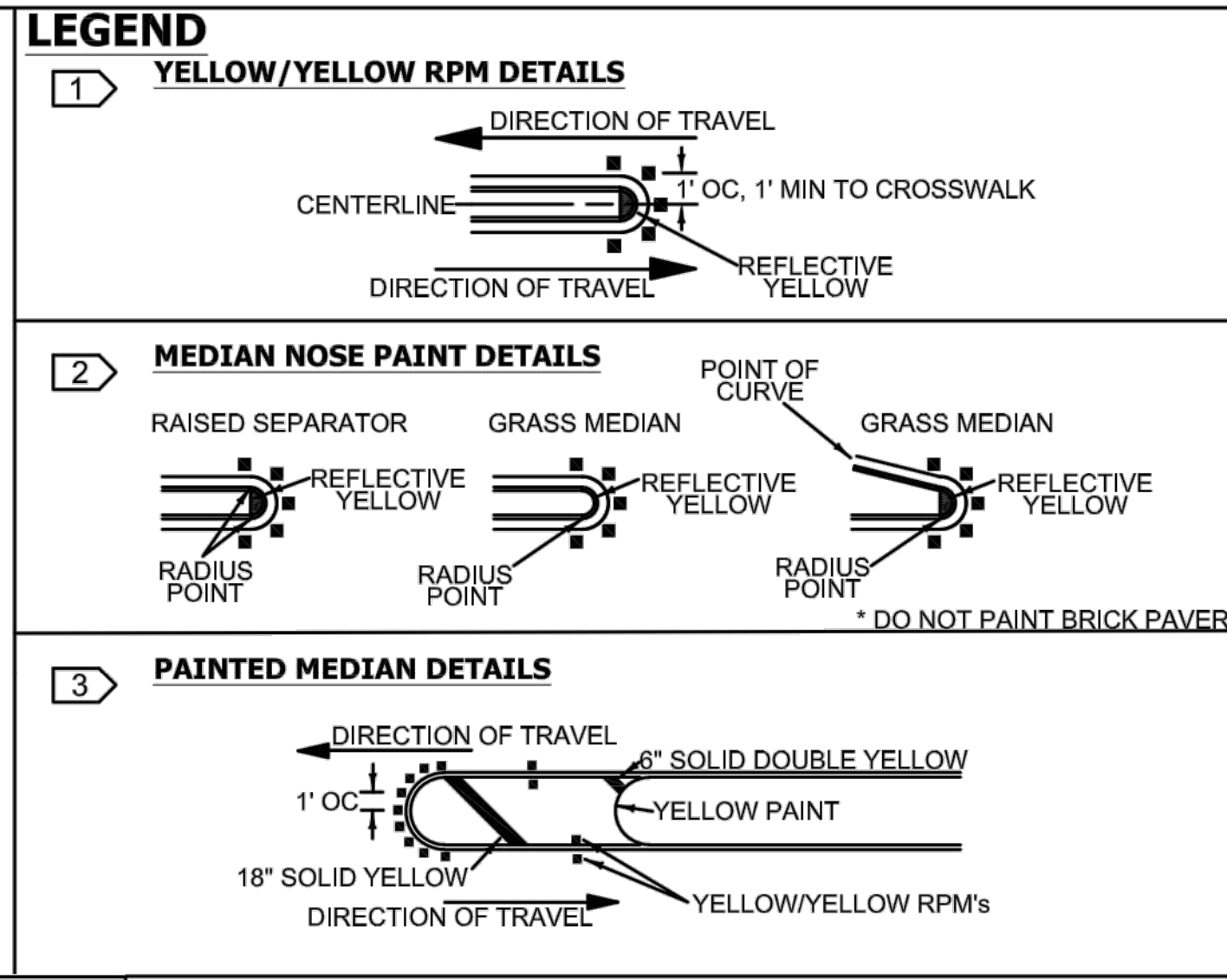

**REVISIONS**

DATE	DESCRIPTION
01-15-2016	N/A
06-11-2018	UPDATED FDOT INDEX REFERENCE
08-23-2018	UPDATED NOTES



PUBLIC WORKS DEPARTMENT  
 TRAFFIC ENGINEERING DIVISION

DESIGN BY: CARMELO CARATTOZZOLO, P.E.  
 DRAWN BY: STEPHON RAMOUTAR  
 CHECKED BY: ANDREW SEBO, P.E., PTOE

**PAVEMENT MARKINGS  
 AND SIGNS  
 DETAILS**

SHEET  
 NO.  
 1 OF 1

**NO EXCLUSIVE RIGHT**

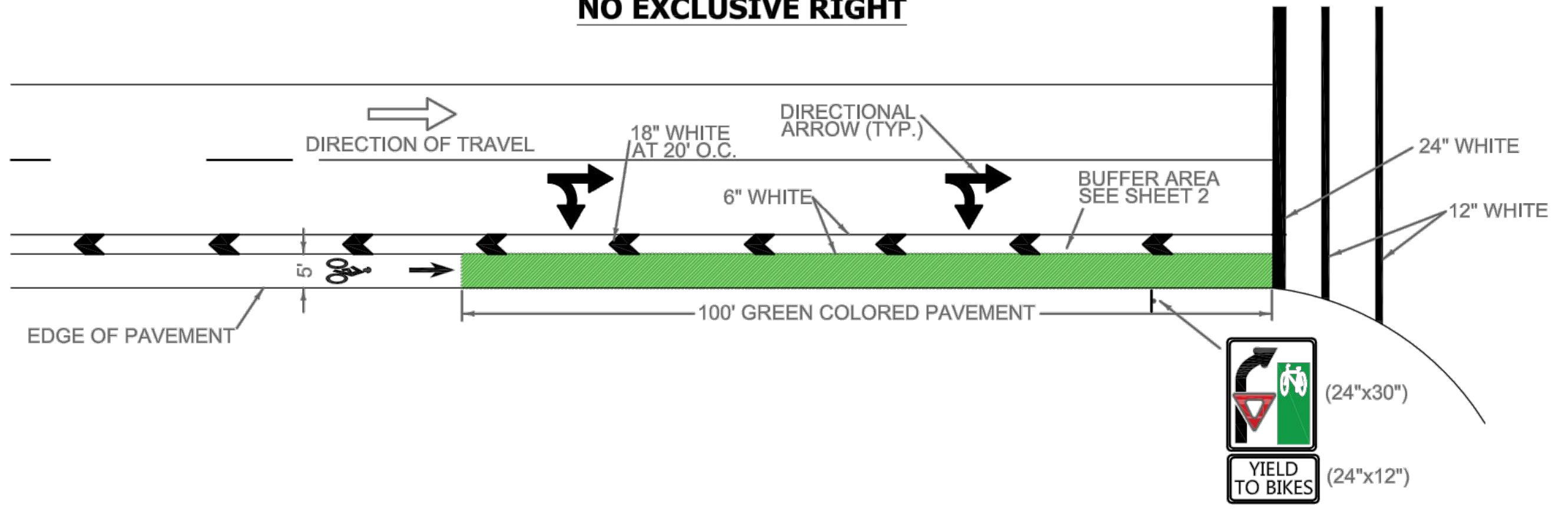

**LEGEND**

GREEN PATTERNED PAVEMENT

**BIKE LANE WITH SEPARATE RIGHT TURN LANE**

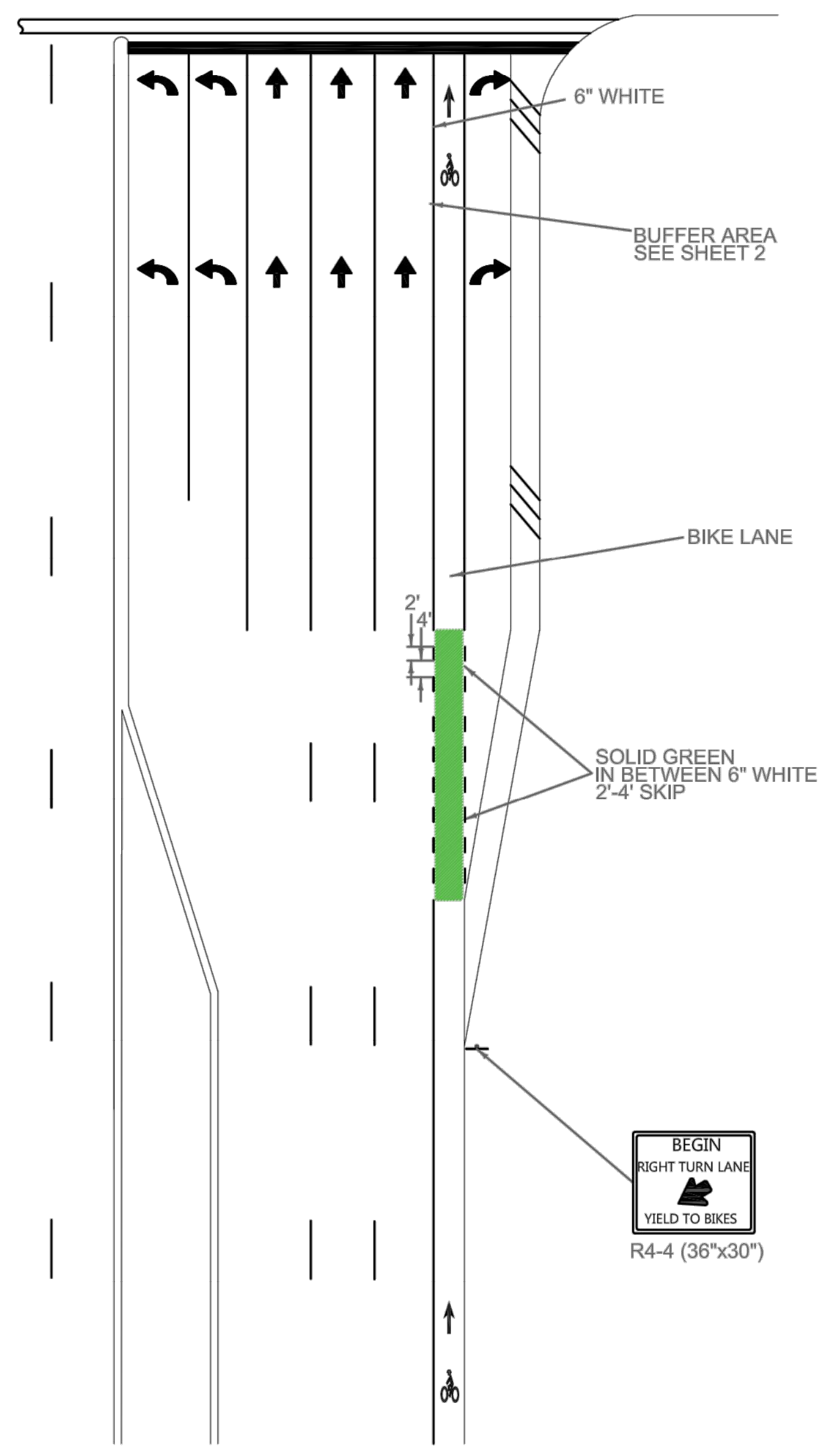

**BIKE LANE WITH RIGHT TURN DROP LANE**

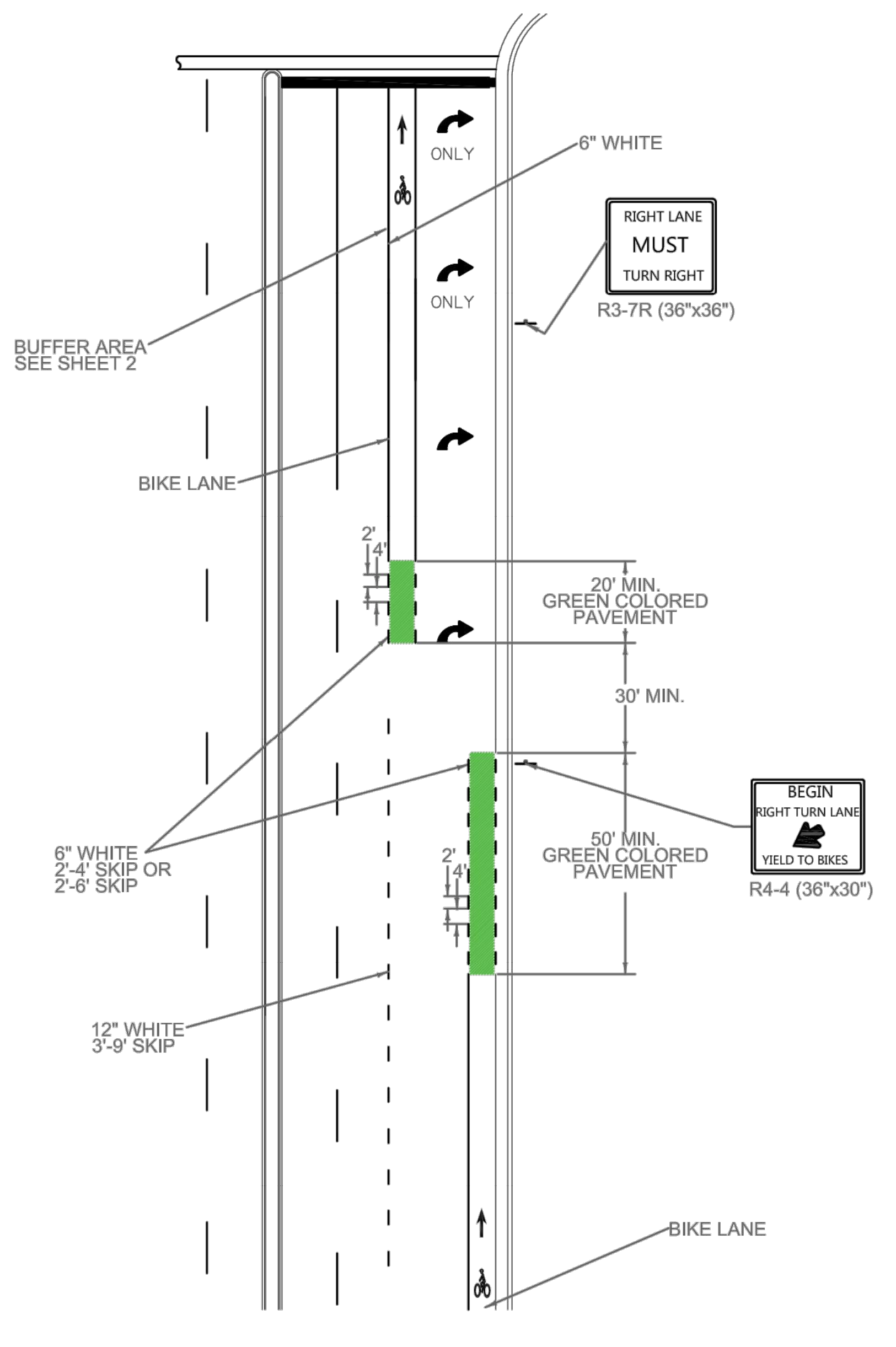

**BICYCLE PAVEMENT MARKING STANDARDS**

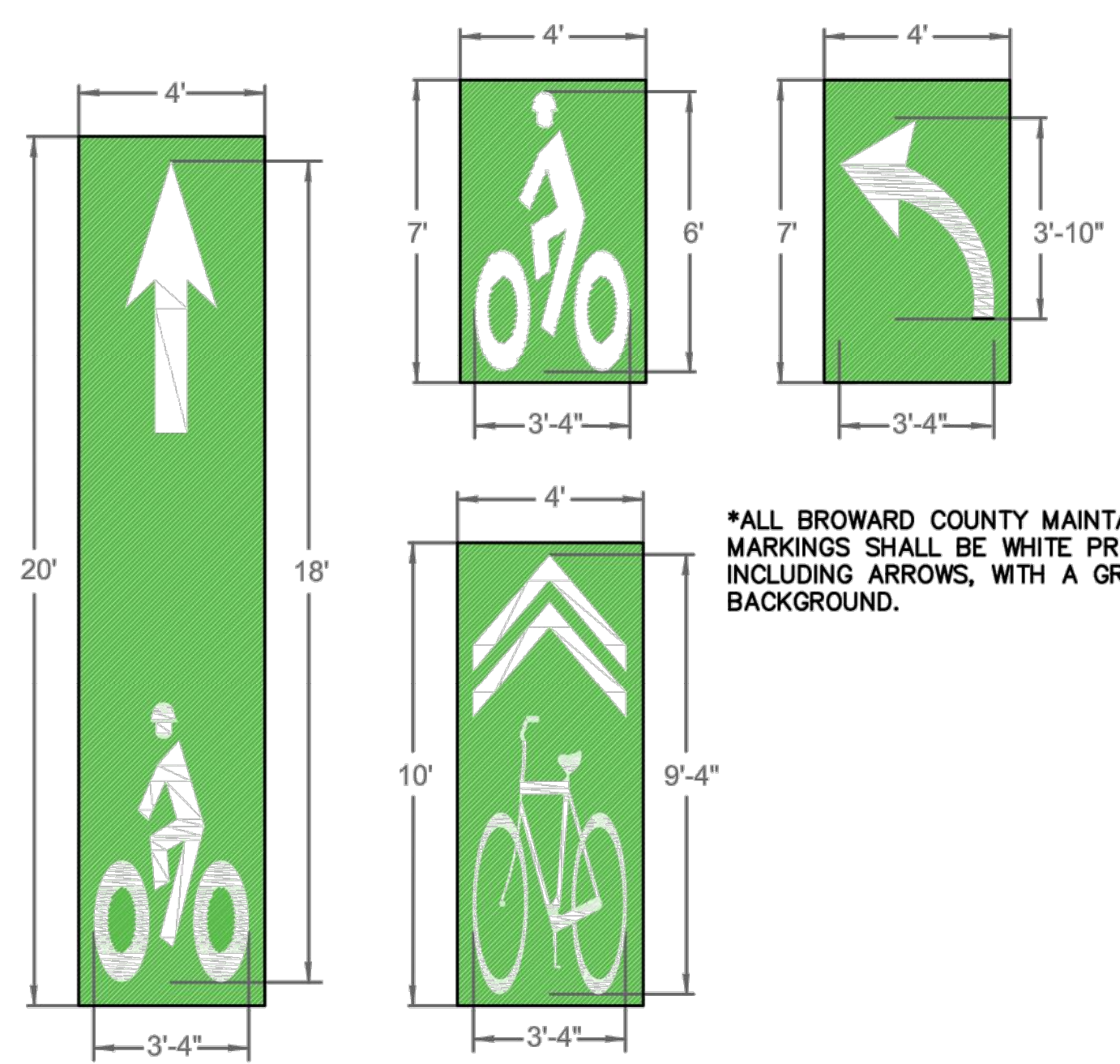

\*ALL BROWARD COUNTY MAINTAINED WHITE AND GREEN BICYCLE MARKINGS SHALL BE WHITE PREFORMED THERMOPLASTIC SYMBOLS, INCLUDING ARROWS, WITH A GREEN PREFORMED THERMOPLASTIC BACKGROUND.

**NOTES**

1. THE PREFORMED THERMOPLASTIC MARKINGS SHALL MEET STATE SPECIFICATIONS AND BE APPROVED FOR USE BY THE APPROPRIATE MAINTAINING AGENCY. GREEN AND WHITE PREFORMED THERMOPLASTIC MARKINGS MUST BE ON THE FDOT APL SPECIFICATION 523 FOR GREEN AND 711 FOR WHITE PREFORMED THERMOPLASTIC MARKINGS.
2. THE SURFACE OF THE PREFORMED THERMOPLASTIC MATERIAL SHALL CONTAIN FACTORY APPLIED NON-SKID MATERIAL WITH A MINIMUM HARDNESS OF 8 (MOHS SCALE). UPON APPLICATION THE MATERIAL SHALL PROVIDE A MINIMUM SKID RESISTANCE VALUE OF 60 BPN WHEN TESTED ACCORDING TO ASTM E 303.
3. THE MATERIAL MUST BE APPLIED AT A MINIMUM THICKNESS OF 90 MILS (2.29 MM) OR 125 MILS (3.15 NUN).
4. THE MATERIAL MUST CONTAIN A MINIMUM OF THIRTY PERCENT (30%) INTERMIXED GRADED GLASS BEADS BY WEIGHT. THE INTERMIXED BEADS SHALL BE CLEAR AND TRANSPARENT. NO MORE THAN TWENTY PERCENT (20%) SHALL CONSIST OF IRREGULAR FUSED SPHEROIDS OR SILICA
5. THE MATERIALS SHALL BE APPLIED USING THE PROPANE TORCH METHOD RECOMMENDED BY THE MANUFACTURER. THE MATERIAL MUST BE APPLIED WITHOUT PREHEATING OF THE PAVEMENT TO A SPECIFIC TEMPERATURE. FOR CONCRETE APPLICATION, A COMPATIBLE PRIMER SEALER MAY BE APPLIED BEFORE APPLICATION TO ASSURE PROPER ADHESION.

REVISIONS	
DATE	DESCRIPTION
07-31-2017	N/A



PUBLIC WORKS DEPARTMENT  
 TRAFFIC ENGINEERING DIVISION

DESIGN BY: CARMELO CARATOZZOLO, P.E. SCALE: NTS  
 DRAWN BY: STEPHON RAMOUTAR  
 CHECKED BY: ANDREW SEBO, P.E., P.T.O.E

**BICYCLE PAVEMENT  
 MARKINGS AND SIGNS  
 DETAILS**

SHEET NO.  
 1 OF 2

### SPECIAL AREA MARKING DETAIL # 1

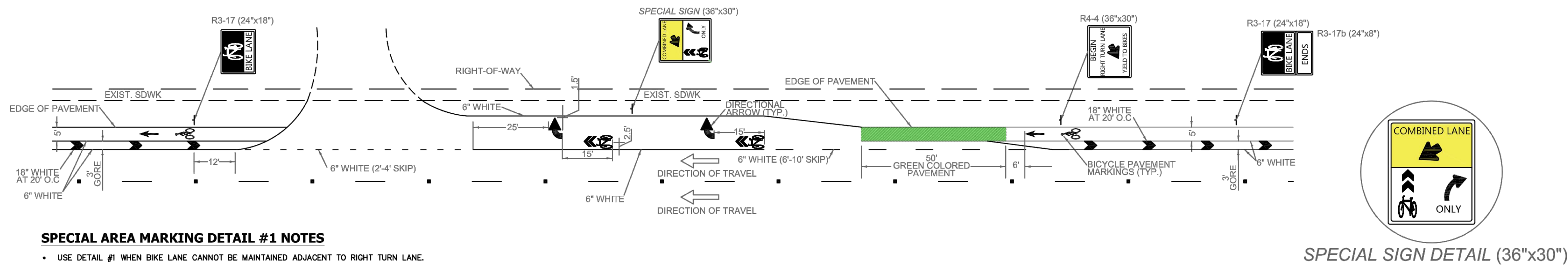

#### SPECIAL AREA MARKING DETAIL #1 NOTES

- USE DETAIL #1 WHEN BIKE LANE CANNOT BE MAINTAINED ADJACENT TO RIGHT TURN LANE.

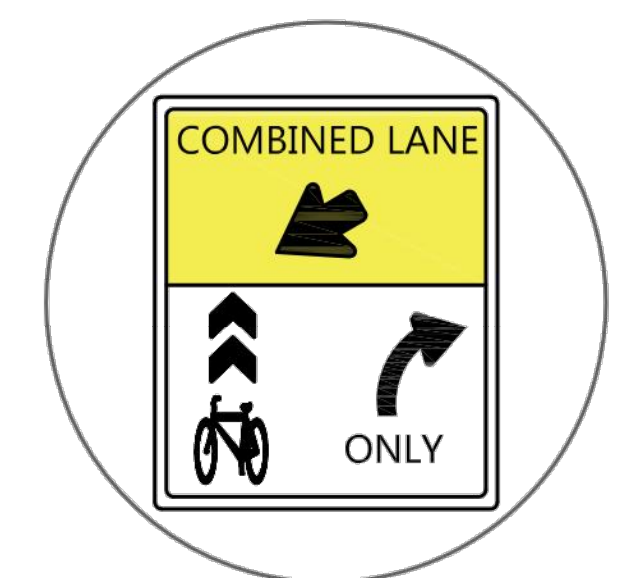

SPECIAL SIGN DETAIL (36"x30")

#### TYPICAL SECTION: TRANSPORTATION COMPONENTS

Functional Classification	Posted Speed (MPH)	Bicycle Space		On-Street Parallel Parking Requested Through Land Development Code Process for Context Sensitive Corridor Designation	
		Bicycle Lane **	Buffer ***	Door Zone This is in addition to the bicycle space ^^^	Parking Space Measured from curb face ****
Local Streets	30 or less	N/A	N/A	4'	7'
Residential Collector	30 or less	4'-5'^	2'-3'^	4'	7'
Collector & Above	35	4'-5'^	2'-3'^	4'	7'
Collector & Above	40	4'-5'	2'-3'	4'-5'	7'
Minor Arterial	45 or less	4'-5'	2'-3'	4'-5'	7'
Principal Arterial	55 or less	5'-6'	3' or Greater	N/A	N/A

#### TYPICAL SECTION: TRANSPORTATION COMPONENTS NOTES

- \*\* A FIVE-FOOT BICYCLE LANE IS THE COUNTY'S TARGET BICYCLE LANE WIDTH
- \*\*\* IF A BUFFER CAN BE INCORPORATED, THREE FEET IS THE TARGET BUFFER WIDTH. A FOUR-FOOT BIKE LANE WITH A THREE-FOOT BUFFER IS PREFERRED TO A FIVE-FOOT BICYCLE LANE WITH A TWO-FOOT BUFFER. IF A BUFFER CANNOT BE PROVIDED, A SOLID DOUBLE 6 INCH WHITE LINE WITH 8 INCH GAP WILL BE USED AS THE BIKE LANE STRIPE. THE BUFFER AREA SHOULD INCLUDE CHEVRON PAVEMENT MARKINGS. SEE BIKE BUFFER LANE OPTIONS.
- \*\*\*\* IF CURB AND GUTTER DOES NOT EXIST, THE PARKING SPACE WOULD BE EIGHT FEET WIDE MEASURED FROM THE EDGE OF PAVEMENT. PEDESTRIAN AND BICYCLE SPACE TAKES PRIORITY OVER ON-STREET PARKING WHEN RIGHT-OF-WAY IS LIMITED.
- ^ SLM - SHARED LANE MARKING (FDOT STANDARD INDEX 17347) CAN BE USED ON COLLECTORS AND ABOVE WHEN APPROPRIATE.
- ^^ WILL CONSIDER A THREE-FOOT DOOR ZONE ON A CASE-BY-CASE BASIS.

#### BIKE BUFFER LANE - OPTIONS

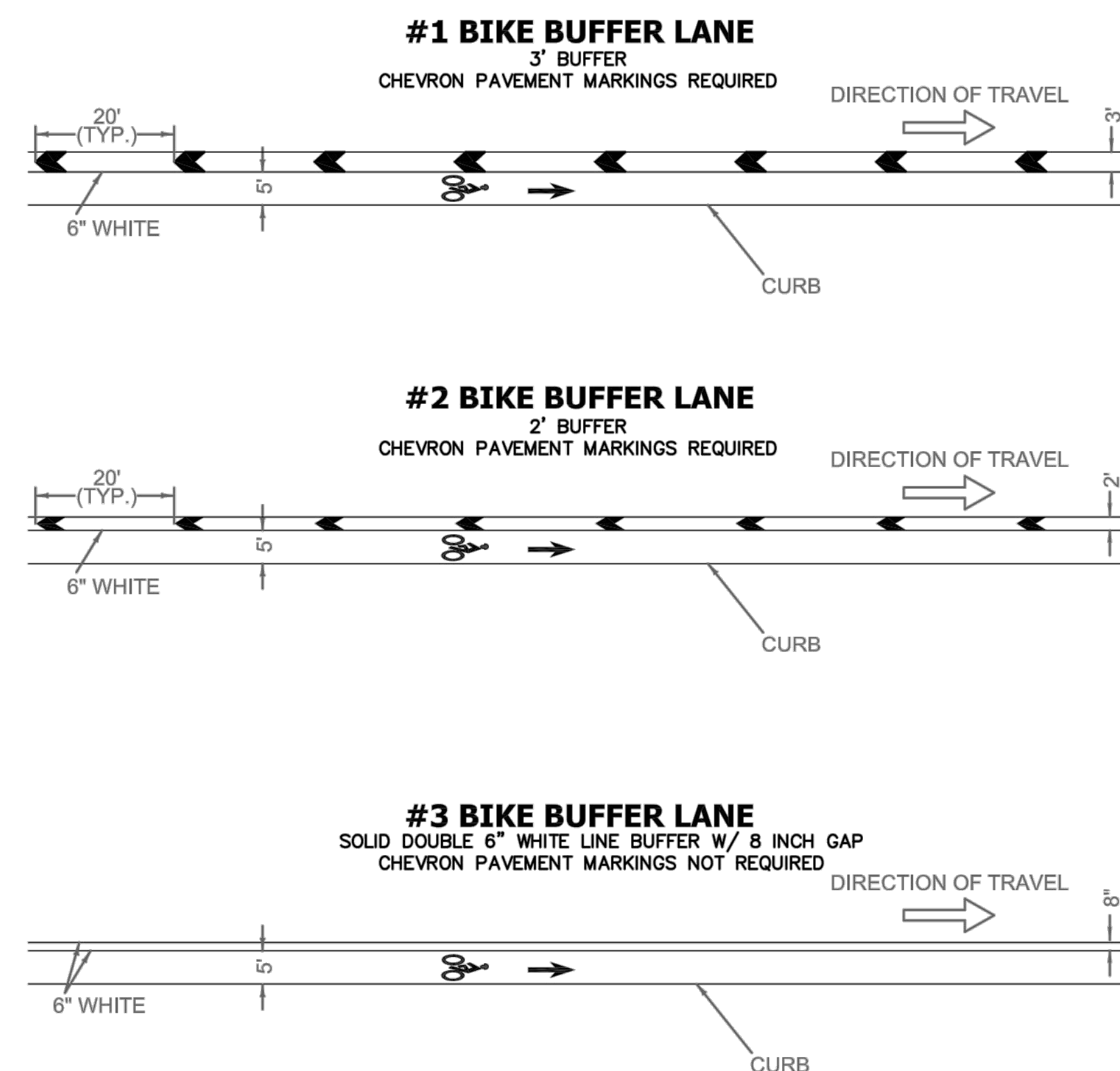

#### BIKE BUFFER LANE OPTIONS NOTES

1. OPTION #1 IS DESIRED FIVE FOOT BICYCLE LANE WITH THREE FOOT BUFFER.
2. IF OPTION #1 CANNOT BE ACHIEVED THEN CONSIDER OPTION #2 AND OPTION #3



PUBLIC WORKS DEPARTMENT  
TRAFFIC ENGINEERING DIVISION

DESIGN BY: CARMELO CARATTOZZOLO, P.E.    SCALE: NTS  
 DRAWN BY: STEPHON RAMOUTAR  
 CHECKED BY: ANDREW SEBO, P.E., P.T.O.E

## BICYCLE PAVEMENT MARKINGS AND SIGNS DETAILS

SHEET NO.  
2 OF 2

REVISIONS	
DATE	DESCRIPTION
07-31-2017	N/A